

# ATTACHER FIXION 2

## ENG

Translation of the original  
user guide

### USER GUIDE

29\_133084\_B  
05/2018

READ THE USER'S GUIDE CAREFULLY BEFORE USE



### CONTENT OF THE CARRY-CASE

- A FIXION 2 tying machine
- A user guide
- Warranty card
- A charger with adapters
- Disgorging scissors
- A holster
- A belt
- A small coil with reel adaptable for use with the tool
- A large coil with lateral reel



# PELLENC

Quartier Notre-Dame  
84120 Pertuis (FRANCE)  
Tél : +33 (0)4 90 09 47 00  
Fax : +33 (0)4 90 09 64 09  
[www.pellenc.com](http://www.pellenc.com)



# TABLE OF CONTENTS

<b>SAFETY INSTRUCTIONS</b>	<b>4</b>
INTRODUCTION	4
GENERAL SAFETY INSTRUCTIONS FOR THE TOOL	5
<b>DESCRIPTION AND TECHNICAL CHARACTERISTICS</b>	<b>8</b>
TECHNICAL PROPERTIES	9
<b>PREPARATION BEFORE FIRST USE OF THE TOOL</b>	<b>10</b>
SETTING UP BELT AND HOLSTER	10
PUTTING LATERAL DISPENSER FITTED WITH THE LARGE COIL ONTO THE BELT	10
PUTTING ADAPTABLE DISPENSER FITTED WITH THE SMALL COIL ONTO THE TYING MACHINE	11
<b>FIRST USE OF THE TOOL</b>	<b>12</b>
TYING MACHINE ON/OFF	12
ADJUSTING THE TIGHTNESS OF THE TIE	12
END OF COIL	12
RELOAD THE LARGE COIL	14
RELOAD THE SMALL COIL	15
INSERT THE CORD INTO THE TYING MACHINE	16
USE	17
<b>CHARGING THE TOOL</b>	<b>19</b>
(INSTRUCTIONS BEFORE CHARGING BUILT-IN BATTERY)	19
THE DISPLAY SHOWING REMAINING BUILT-IN BATTERY CAPACITY	19
CHARGING THE BUILT-IN BATTERY	19
<b>MAINTENANCE</b>	<b>22</b>
CHARGER	22
BUILT-IN BATTERY	22
MISC. MAINTENANCE	22
BUILT-IN BATTERY REPLACEMENT	23
WHEN NOT IN USE	23
<b>INCIDENTS</b>	<b>24</b>
SUMMARY OF CHARGE INDICATOR AND BEEP MESSAGES	24
<b>PELLENC WARRANTY AND AFTER SALES SERVICE</b>	<b>25</b>
<b>"EC" STATEMENT OF COMPLIANCE</b>	<b>26</b>

## SAFETY INSTRUCTIONS

### ► INTRODUCTION

Dear Customer,

Thank you for buying the Pellenc **FIXION 2 attacher**. Correctly used and maintained, this tool will give a satisfactory performance for years to come.



#### ENVIRONMENTAL PROTECTION

Your equipment comprises numerous materials which can be valorised or recycled. Entrust these to your reseller or to an approved service centre so that they can be processed.

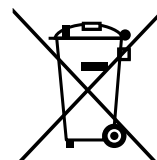

Comply with the regulations in force in your country as concerns environmental protection associated with your activity.



**CAUTION** You must read the whole of this user guide before using the tool or before carrying out servicing operations.

Comply scrupulously with the instructions and illustrations given in this document.

All through this user guide you will find advisory notes and information entitled: **REMARK, CAUTION / WARNING**.

A **REMARK** provides additional information, clarifies a point or explains a step to be followed in detail.

The **CAUTION** and **WARNING** advisories are used to define a procedure which, if neglected or incorrectly performed, may lead to serious damage to the equipment and/or personal injury.

This advisory:  indicates that if the procedures or instructions are not complied with, any damage will not be covered by the warranty and the owner will be responsible for the repair costs.

Safety indications are also given on the tool; they remind you of the safety precautions to be taken. Identify and read these indications before using the tool. Immediately replace any indications that may become partially illegible or deteriorated.

**Refer to the «SAFETY INDICATIONS» heading in order to identify the location of the safety indications on the tool.**

No part of this manual may be reproduced without the written consent of PELLENC. The illustrations given in this manual are for information purposes and are in no way contractual. PELLENC reserves the right to make any modification or improvement to its products as deemed necessary without informing customers already in possession of a similar model. This manual forms an integral part of the tool and must accompany the tool if it changes hands.

**SAFETY INSTRUCTIONS****► GENERAL SAFETY INSTRUCTIONS FOR THE TOOL**

**CAUTION** Read all the safety measures, instructions, illustrations and specifications provided with this power tool. *Failure to comply with the following instructions risks causing electric shock, fire and/or serious injury.*

**RETAIN ALL THE SAFETY MEASURES AND INSTRUCTIONS FOR LATER READING.**

The term “power tool” in the safety instructions refers to your mains-powered tool (with power cable) or your battery-powered tool (without power cable).

**WORK AREA SAFETY**

- a) **Keep the work area clean and well lit.** *Cluttered or dark areas invite accidents.*
- b) **Do not operate power tools in an explosive atmosphere, for example in the presence of flammable liquids, gases, or dust.** *Power tools create sparks, which can ignite dust or fumes.*
- c) **Keep children and bystanders away while operating the power tool.** *Distractions can cause you to lose control of the tool.*

**ELECTRICAL SAFETY**

- a) **The power tool connector must be adapted to the socket. Never modify the connector in any way whatsoever. Do not use adapter plugs with earthed (grounded) power tools.** *Unmodified plugs and suitable sockets reduce the risk of electric shock.*
- b) **Avoid contact with earthed surfaces such as pipes, radiators, cookers, and refrigerators.** *There is an increased risk of electric shock if your body is in direct contact with the ground.*
- c) **Do not expose power tools to rain or damp conditions.** *The entry of water into a power tool increases the risk of electric shock.*
- d) **Do not mishandle the power cord. Never use the cord for carrying, pulling or unplugging the power tool. Keep cord away from heat, oil, sharp edges, and moving parts.** *Damaged or entangled cords increase the risk of electric shock.*
- e) **Use an extension cord suitable for outdoor use when operating power tools outdoors.** *Use a cord suitable for outdoor to reduce the risk of electric shock.*
- f) **Use a power supply protected by a residual current device (RCD) when the power tool is operated in a damp location.** *Use of a RCD reduces the risk of electric shock.*  
*NOTE: The term “Residual Current Device” (RCD) can be replaced by “Ground Fault Circuit Interrupter” (GFCI) or “Earth Leakage Circuit Breaker” (ELCB).*

## SAFETY INSTRUCTIONS

### PERSONAL SAFETY

- a) **Stay alert, watch what you are doing, and use common sense when operating the power tool. Do not use a power tool when you are tired or under the influence of drugs, alcohol, or medication.** *A moment of inattention when using a power tool can result in serious personal injury.*
- b) **Use personal protective equipment. Always wear eye protection.** *Safety equipment such as dust masks, non-slip safety shoes, helmets, or ear protection used at the appropriate times reduces injuries.*
- c) **Avoid accidental starting of the tool. Make sure the switch is in the off position before you connect the tool to the power source and/or battery pack, pick it up, or carry it.** *Carrying a power tool with your finger on the switch or connecting a power tool with the switch in the 'on' position can cause accidents.*
- d) **Remove any adjusting wrench before switching the electric tool on.** *A wrench left attached to a rotating part can cause injury.*
- e) **Do not rush. Keep proper footing and balance at all times.** *This provides better control of the power tool in unexpected situations.*
- f) **Dress appropriately. Do not wear loose clothing or jewellery. Keep hair and clothing away from moving parts.** *Loose clothing, jewellery or long hair can get caught in moving parts.*
- g) **If devices are provided for connecting dust extraction and collection equipment, ensure that these are connected and properly used.** *Use dust collectors to reduce the risk caused by dust.*
- h) **Be vigilant and do not neglect the safety principles of the tool under the pretext that you are used to using it.** *A split second of inattention can lead to serious injury.*

### USE AND CARE OF THE POWER TOOL

- a) **Do not force the power tool. Use the power tool suited for the job.** *The adapted power tool does the work better and more safely at the speed it was built to operate at.*
- b) **Do not use the power tool if the switch does not allow it to be switched on and off.** *Power tools that cannot be controlled by a switch are dangerous and must be repaired.*
- c) **Unplug the tool from the socket or remove the battery (if possible) before any adjustment, change of accessory or storage.** *These preventive safety measures reduce the risk of accidentally starting the power tool.*
- d) **When not in use, keep power tools out of the reach of children and do not allow persons unfamiliar with the power tool or these instructions to operate it.** *Power tools are dangerous when operated by inexperienced users.*
- e) **Maintenance of the power tool and its accessories is mandatory. Check that the moving parts are not out of alignment or jammed, that there are no broken parts or that there is no other condition which could affect the operation of the power tool. If damaged, repair the power tool before using it.** *Many accidents are due to poorly maintained power tools.*
- f) **Keep the cutting elements sharp and clean.** *Properly maintained cutting tools with sharp cutting elements are less likely to jam and are easier to control.*
- g) **Use the power tool, accessories, blades, etc. in accordance with these instructions, taking into account the working conditions and the work to be done.** *Using the power tool for operations other than those specified can result in hazardous situations.*
- h) **Keep the handles and gripping surfaces must dry, clean and free of oil and grease.** *Slippery handles and gripping surfaces make it impossible to safely handle and control the tool in unexpected situations.*

## ■ SAFETY INSTRUCTIONS

### USING BATTERY-OPERATED TOOLS AND SAFETY PRECAUTIONS.

- a) **Recharge only with the charger specified by the manufacturer.** *A charger suitable for a specific battery pack may create a fire hazard when used with another type of battery pack.*
- b) **Only use the tools with specifically designated battery packs.** *Use of any other battery pack may create a risk of injury and fire.*
- c) **When a battery pack is not being used, store it away from metal objects such as paper clips, coins, keys, nails, screws and other small items that can create a connection between the terminals.** *A short-circuit between the battery terminals may cause burns or fire.*
- d) **If in bad condition, a liquid may be ejected from the battery; avoid all contact. In the event of accidental contact, clean with water. If the liquid gets into your eyes, seek medical help.** *The liquid ejected from the batteries can cause irritation and burns.*
- e) **Do not use a battery pack or battery-operated tool that is damaged or modified.** *Damaged or modified batteries can have unpredictable behaviour causing fire, explosion or risk of injury.*
- f) **Do not expose a battery pack or battery-operated tool to fire or excessive temperatures.** *Exposure to fire or a temperature above 130° C (265° F) may cause an explosion.*
- g) **Follow all charging instructions and do not charge the battery pack or battery-powered tool outside the temperature range specified in the instructions.** *Incorrect charging or charging at temperatures outside the specified temperature range may damage the battery and increase the risk of fire.*

### MAINTENANCE

- a) **Have the power tool serviced by a qualified technician, using only identical spare parts.** *This ensures the continued safety of the power tool.*
- b) **Never carry out maintenance work on damaged battery packs.** *Batteries should only be serviced by the manufacturer or authorised service providers.*

### END OF LIFE MANAGEMENT OF THE TOOL

- a) **When the tool reaches the end of its useful life, PELLENC provides an information sheet for equipment end of life.** *This information sheet provides instructions for the safe withdrawal of the components from service.*

**DESCRIPTION AND TECHNICAL CHARACTERISTICS**

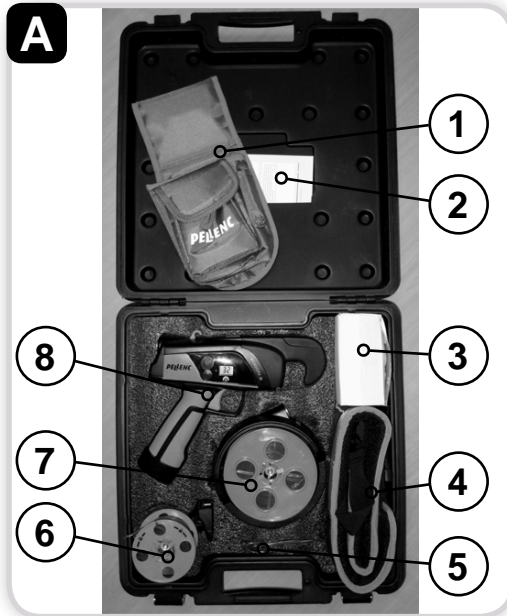

**Complete carry-case**

- 1– Holster
- 2– User guide and warranty card
- 3– Charger unit with adapters
- 4– Belt
- 5– Disgorging scissors
- 6– Small coil with reel adaptable for use with the tool
- 7– Large coil with lateral reel
- 8– Fixion 2 tying machine

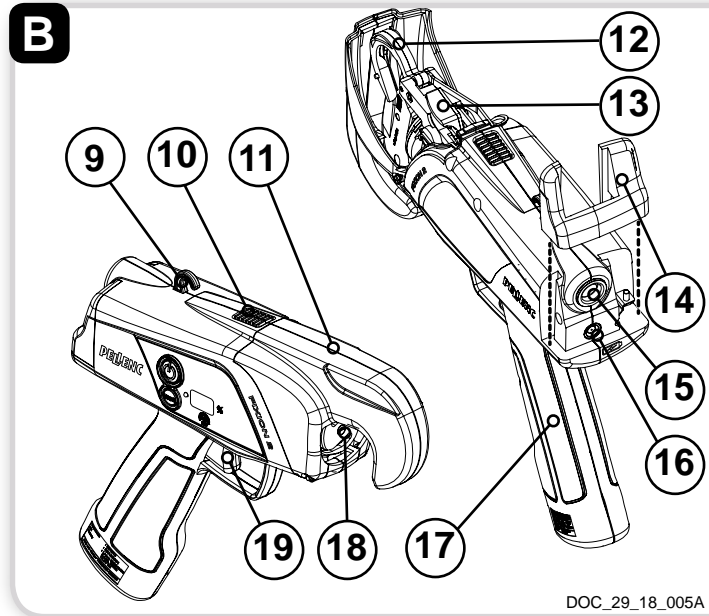

**Fixion 2 tying machine**

- 9– Hanging hook
- 10– Lock button for detachable dispenser
- 11– Swivel dispenser
- 12– Attachment hook
- 13– Upper guide
- 14– Guard
- 15– Inlet for tying cord
- 16– Charging connector
- 17– Handle with built-in battery (lithium-ion battery)
- 18– Twister
- 19– Operating trigger

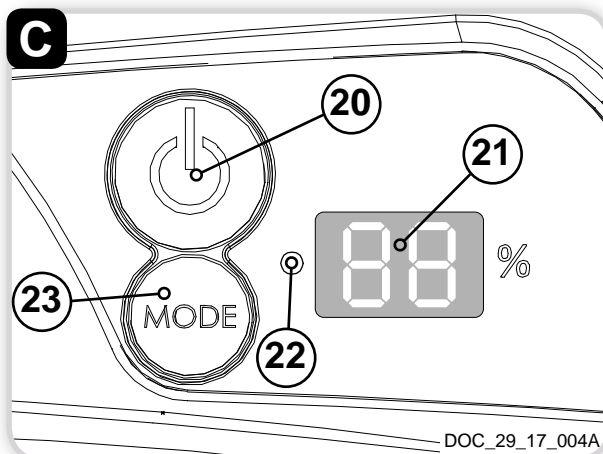

**Fixion 2 display**

- 20– Tool on/off button
- 21– Gauge display
- 22– Power on LED for tool.
- 23– “MODE” button (1 to 4 twist selector)

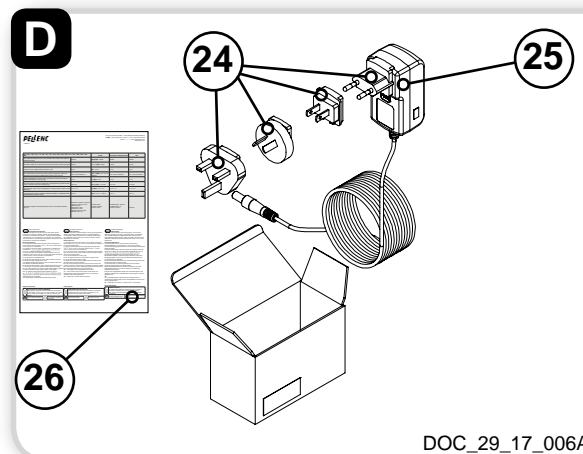

**Fixion 2 charger**

- 24– Connector adapters
- 25– Li-Ion battery charger
- 26– Charger manual



## DESCRIPTION AND TECHNICAL CHARACTERISTICS

### ► TECHNICAL PROPERTIES

Max tying capacity	25 mm
Power supply voltage of tying machine	10.9 V
Charger supply voltage	see requirement on charger
Average charger power	see requirement on charger
Li-Ion battery capacity	38 Wh 3.5 Ah
Charging time	8 hrs
Tying machine operating capacity before recharging	up to 15,000 ties
Large coil cord length (carried by user)	about 200 m/coil
Corresponding no. of ties on large coil	around 1500 ties
Small coil cord length (carried on tool)	about 60 m/coil
Corresponding no. of ties on small coil	around 450 ties
Weight of tying machine alone	800 g.
Weight of tying machine with adaptable reel and small coil	990 g.
Weight of whole assembly worn on belt (lateral reel with large coil)	640 g.

Total vibration values (triax vector sum) determined in accordance with EN 62841-1. (Uncertainty K=1.5 m/s <sup>2</sup> )	$a_h < 2.5 \text{ m/s}^2$ maximum
--	-----------------------------------

Noise value measured according to standard EN 62841-1	
Acoustic power level measured (uncertainty of K=3 dB)	$L_{WA}=81 \text{ dB}$ maximum
Level of acoustic pressure measured at the work station (uncertainty of K=3 dB)	$L_{pA}=70 \text{ dB}$ maximum

## ■ PREPARATION BEFORE FIRST USE OF THE TOOL

### ► SETTING UP BELT AND HOLSTER

- Remove the belt (4) from the carry-case.
- Put the holster (1) in place on the belt (4), on the left or right side according to whether you are left or right-handed.
- Place the belt (4) at your back, around your waist.
- Adjust the length of the belt (4) to fit you.

### ► PUTTING LATERAL DISPENSER FITTED WITH THE LARGE COIL ONTO THE BELT.

- Clip the reel fitted with the large coil onto the belt.

**NOTE:**

The reel cover is placed on the user's right side by default. This is so that the reel clips are on the right of the belt, with the cord outlet towards the front.

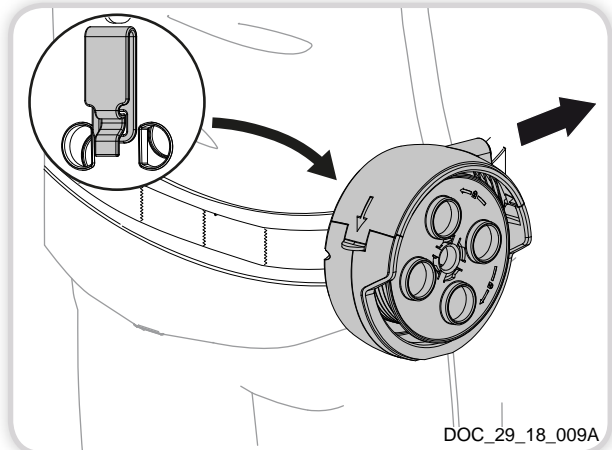

- To switch the cover over to the left-handed version:  
Open the reel cover.  
Unclip the cover.

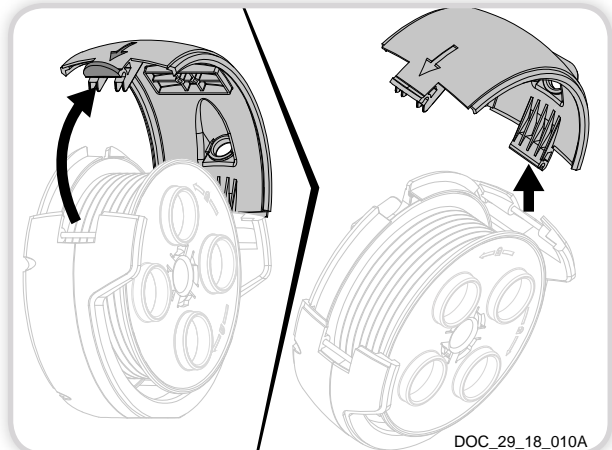

- Reverse the cover and clip it onto the reel.
- Close the cover.

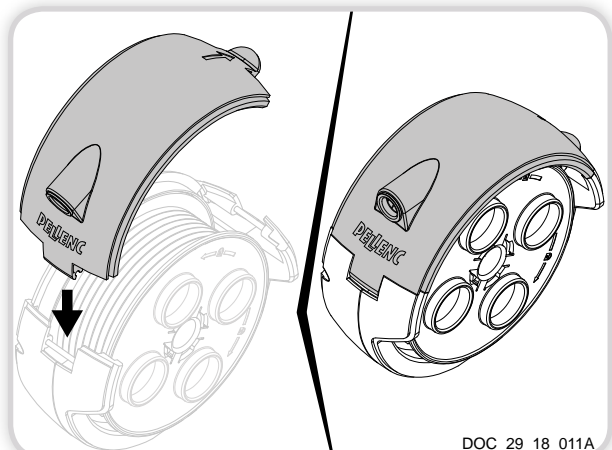

**NOTE:**

In this configuration, the reel clips are on the left of the belt, with the cord outlet towards the front.

## ■ PREPARATION BEFORE FIRST USE OF THE TOOL

### ► PUTTING ADAPTABLE DISPENSER FITTED WITH THE SMALL COIL ONTO THE TYING MACHINE.

- Remove the guard (14) on the back of the tying machine.
- Place the guard (14) into the slot reserved inside the carrycase.

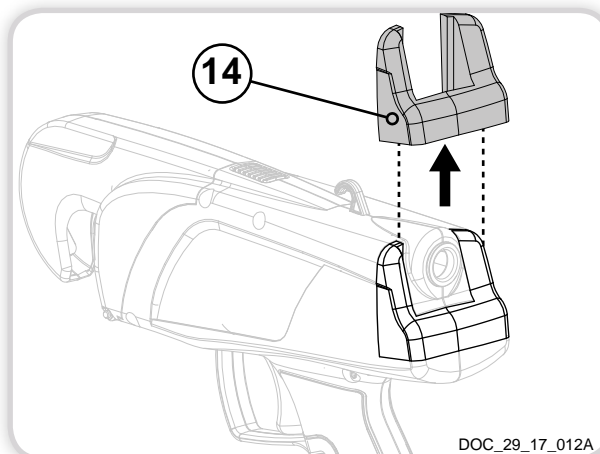

- Put the small coil in place with the adaptable dispenser (6) instead of the guard (14).

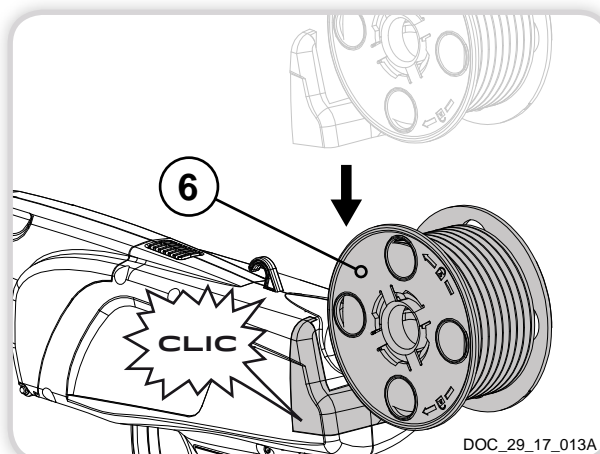

## FIRST USE OF THE TOOL

### ► TYING MACHINE ON/OFF

The tying machine is started and stopped with the on/off button (20).

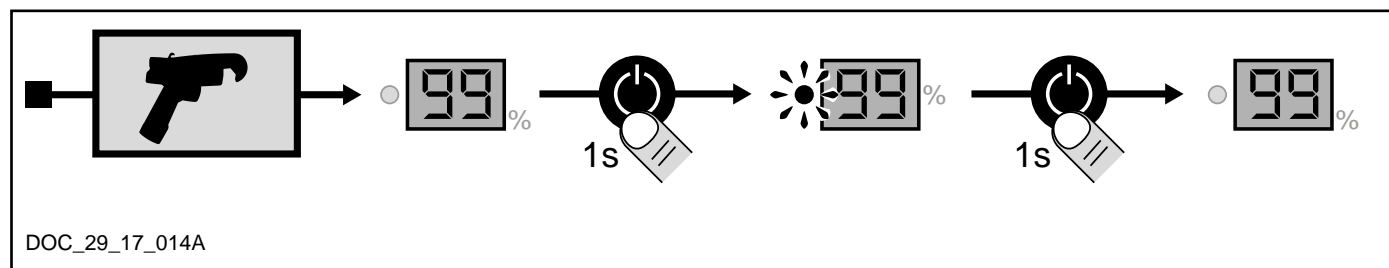

### ► ADJUSTING THE TIGHTNESS OF THE TIE

You can adjust the tightness of the tie to suit the type of wood you have to tie in place, by using the MODE button (23).

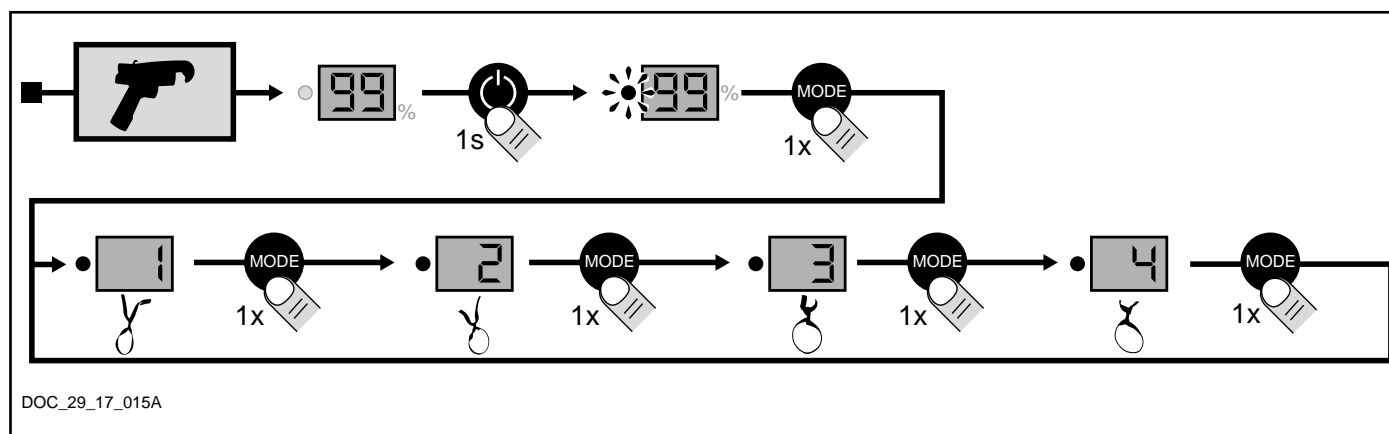

Table of equivalences

"MODE" button	1	2	3	4
Number of twists	3	5	7	8.5

### ► END OF COIL

Before starting work, check the load level of your coil.

When the marker for the end of the cord appears (there is no more cord in the coil-holder) and there is only around ten centimetres of cord visible at the back of the tying machine, stop tying.



**TAKE CARE:**  
THESE OPERATIONS MUST BE DONE EACH TIME THE COIL IS EMPTIED.



**TAKE CARE:**  
DO NOT ALLOW THE TYING MACHINE TO RUN WITHOUT CORD, AS YOU RISK DAMAGING IT.

**FIRST USE OF THE TOOL**

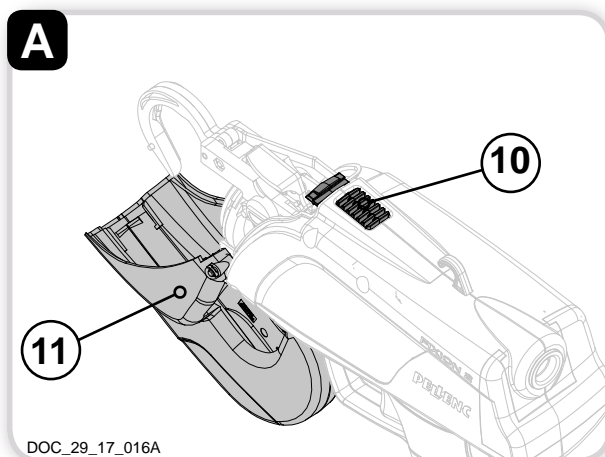

- Turn off the tying machine (on/off button (20), see page 12).
- Open the swivel dispenser (11) with the lock/unlock button (10).

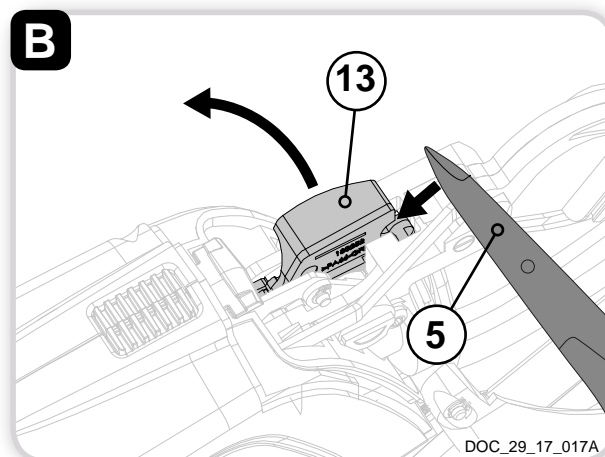

- Remove the upper guide (13) levering it out with the disgorging scissors (5).

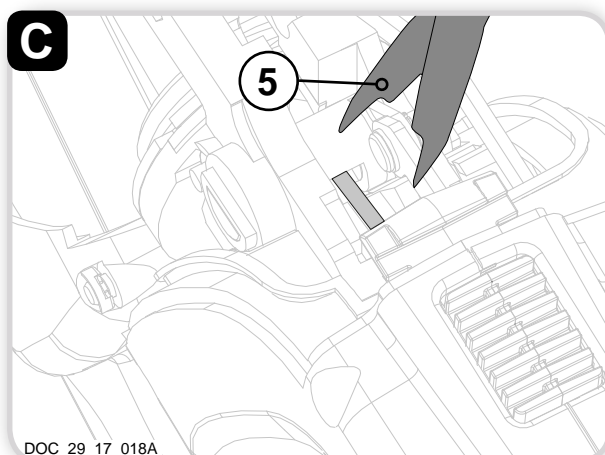

- Turn off the tying machine (on/off button (20), see page 12).
- Extract the remaining cord with the disgorging scissors (5).

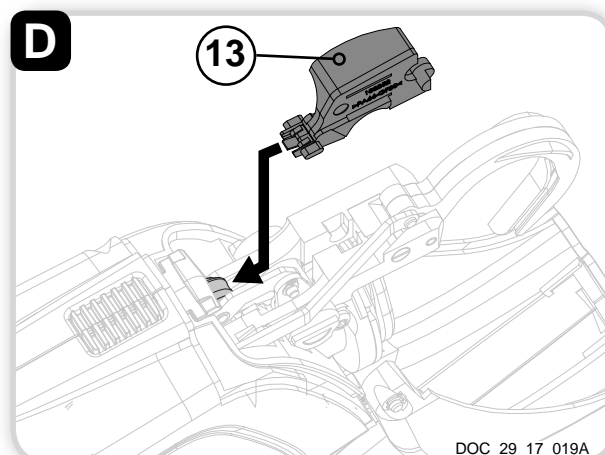

- Insert the upper guide (13) to the end stop, under the support roller.

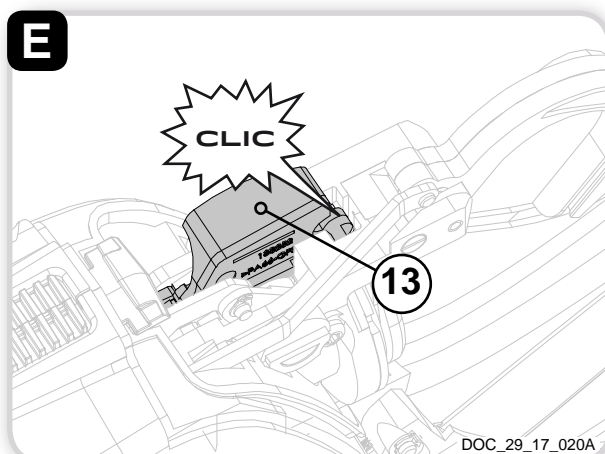

- Clip the upper guide (13) into position.

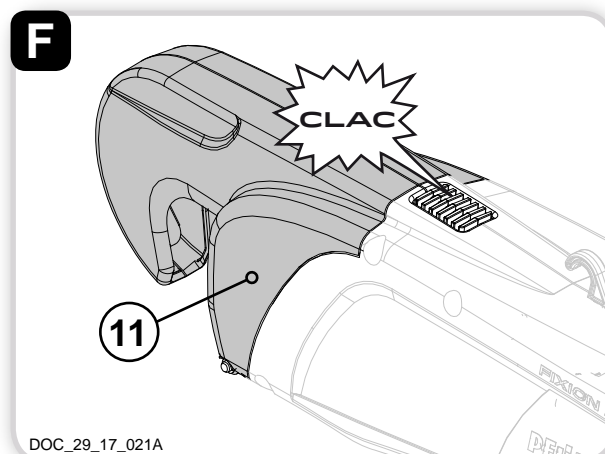

- Close the swivel dispenser (11) again.

## FIRST USE OF THE TOOL

### ► RELOAD THE LARGE COIL

- Block the rear flange and turn the front flange clockwise to unlock it.
- Remove the front flange from the lateral dispenser (7).

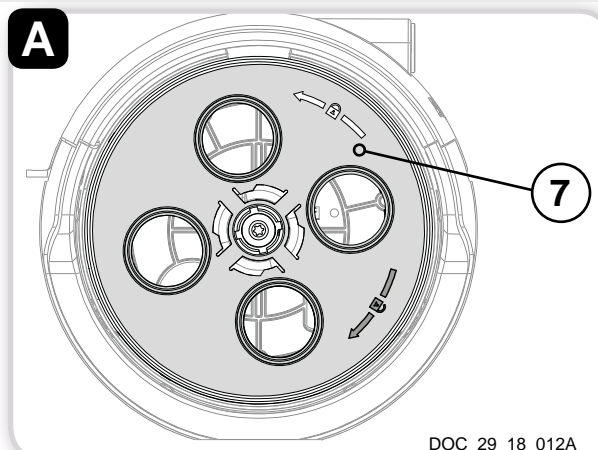

- Put the tie coil in place: Match up the 4 straps with the 4 flats on the hub of the lateral dispenser (7) and make sure the end of the tie is coming out in the right direction.

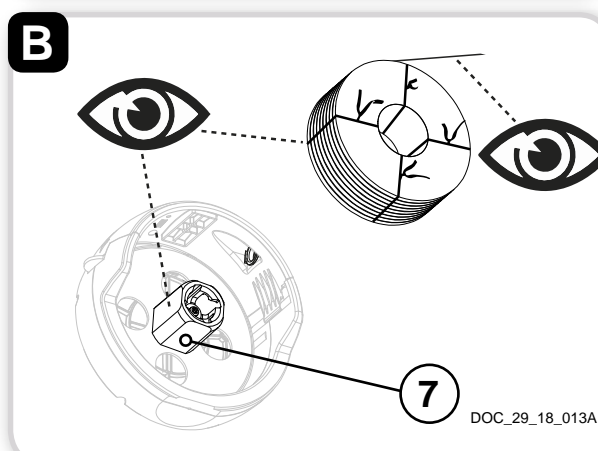

#### NOTE:

The coil must unwind clockwise through the outlet opening of the lateral dispenser (7).

- Replace the front flange on the hub of the lateral dispenser (7).
- Block the rear flange and turn the front flange anti-clockwise to lock it.

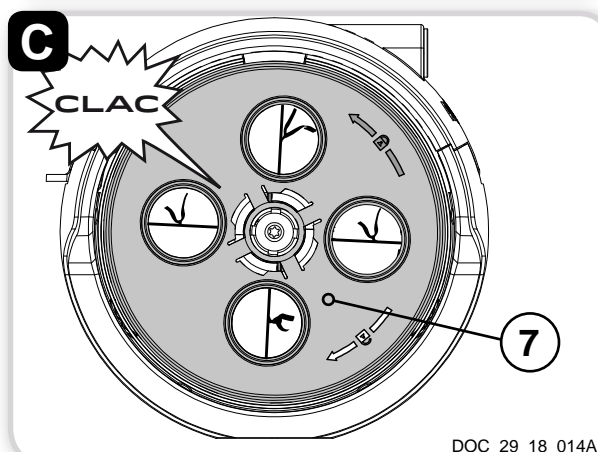

- Open the cover of the reel and pass the cord through the opening.
- Cut and remove the 4 straps with the disgorging scissors (5).
- Close the cover and unwind the cord to the desired length.

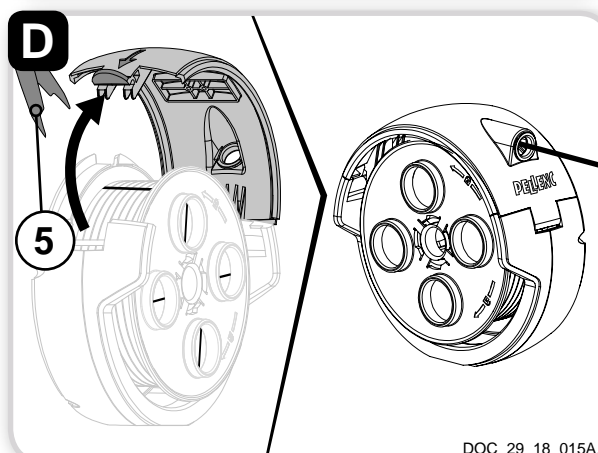

## FIRST USE OF THE TOOL

### ► RELOAD THE SMALL COIL

- Block the rear flange and turn the front flange clockwise to unlock it.
- Remove the front flange from the adaptable dispenser (6).

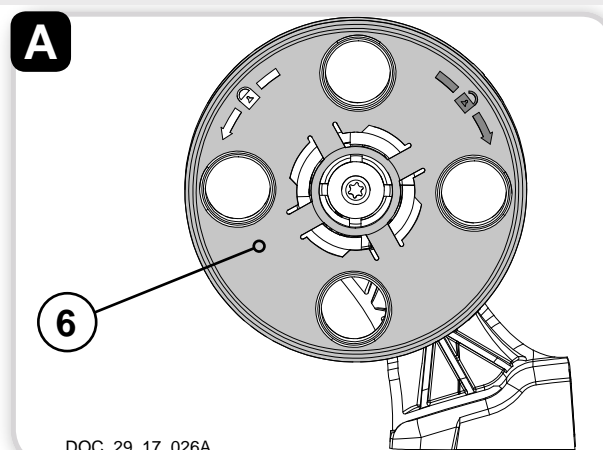

- Put the tie coil in place: Match up the 4 straps with the 4 flats on the hub of the adaptable dispenser (6) and make sure the end of the tie is coming out in the right direction.

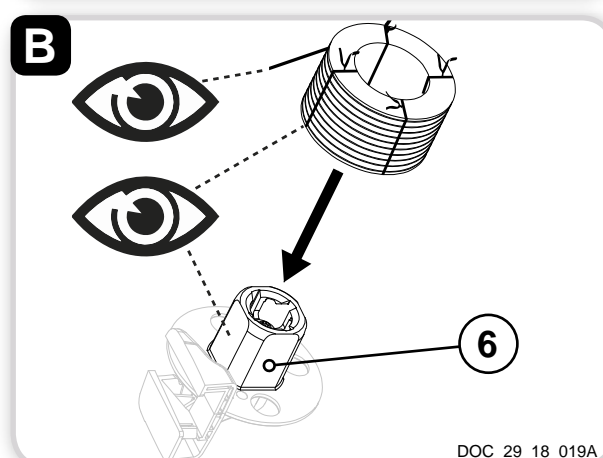

**NOTE:**  
The coil must unwind clockwise.

- Replace the front flange on the hub of the adaptable dispenser (6).
- Block the rear flange and turn the front flange anti-clockwise to lock it.

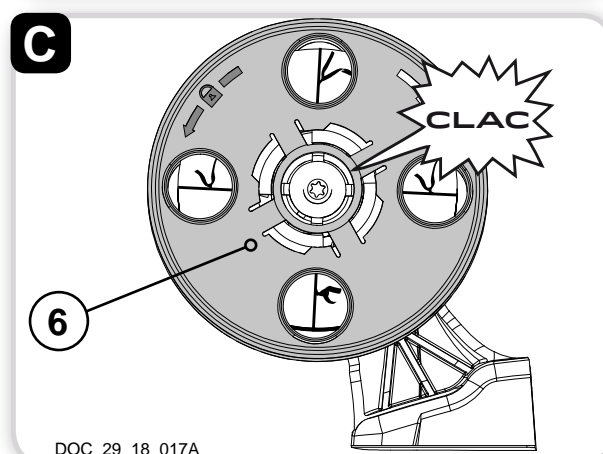

- Cut and remove the 4 straps with the disgorging scissors (5).

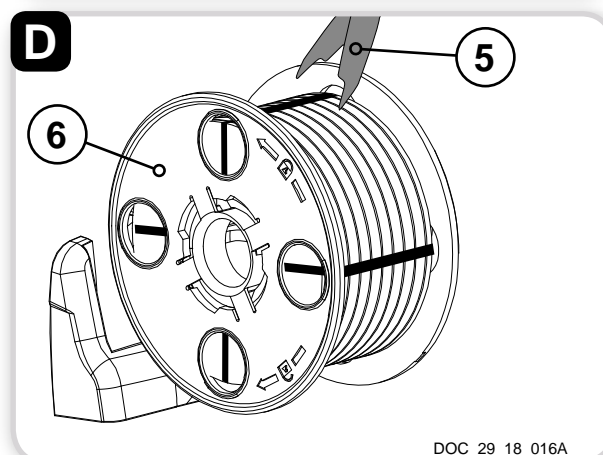



## FIRST USE OF THE TOOL

### ► INSERT THE CORD INTO THE TYING MACHINE

#### A<sup>1</sup> Large coil:

- Insert the tie, flat, into the opening (15) of the tying machine until the tie cord reaches the end stop.

**NOTE:**

The coil must unwind clockwise through the outlet opening of the lateral dispenser (7).

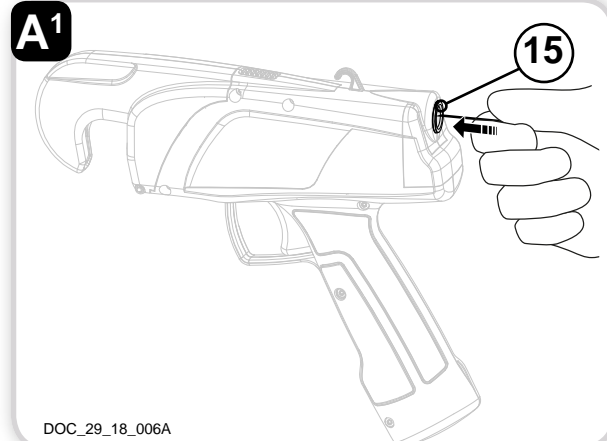

#### A<sup>2</sup> Small coil:

- Insert the tie, flat, into the opening (15) of the tying machine until the tie cord reaches the end stop.
- Make sure the tie is inserted from below and not from above.

**NOTE:**

The coil must unwind clockwise.

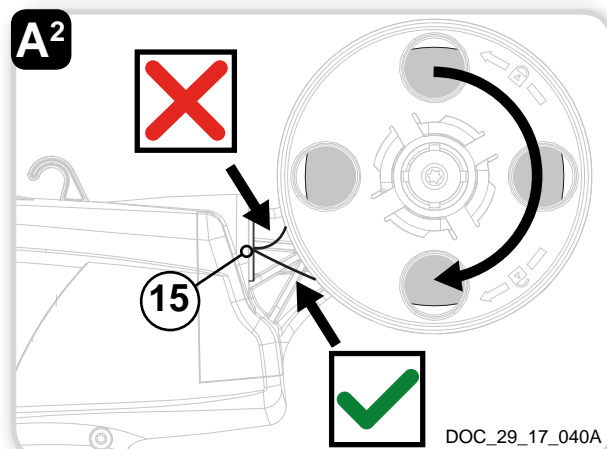

- Start the tying machine going (see page 12).
- Press the trigger (19) (a single press) to push the tie through to the hook (12).

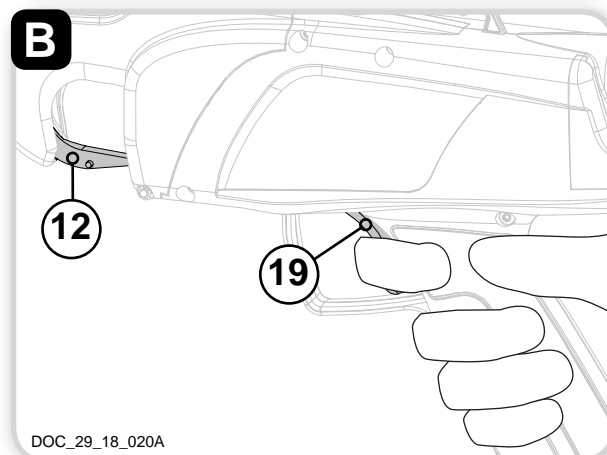

- Check that no scrap of cord remains trapped in the twister (18), make one empty tie to test it, and remove this tie.

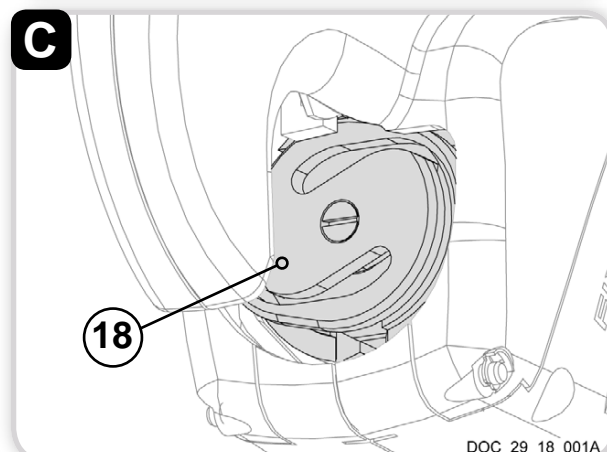



## FIRST USE OF THE TOOL

### ► USE

It takes a few hours handling to become familiar with the tying machine. The tying process is not automatic. To ensure your tool is working properly, and you are comfortable with it, always comply with the following conditions:

- When you use the large coil, keep the assemblies properly aligned: Reel / cord / tying machine
- When you use the small coil, check that the tie has been properly inserted into the intake opening of the tying machine.



**TAKE CARE:**  
THE CORD MUST NOT BE HELD AT THE TYING MACHINE INTAKE.



**TAKE CARE:**  
AVOID ANY MALFUNCTION BY MAKING SURE THE CORD IS NOT BENT AT THE TYING MACHINE INTAKE OPENING.

- Correct position when using the large coil (view from above, with a right-handed user).

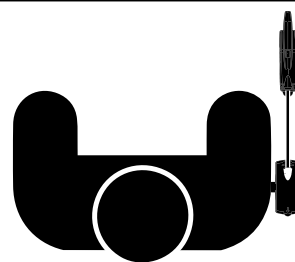

DOC\_29\_17\_043A

- Correct position when using the large coil (view from above, with a left-handed user).

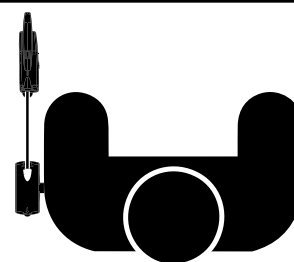

DOC\_29\_17\_044A

- Incorrect position when using the large coil (view from above, with a user carrying the reel on the back).

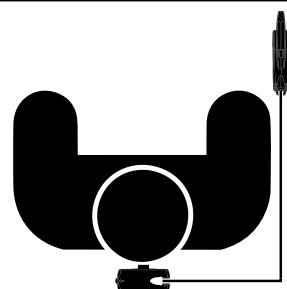

DOC\_29\_17\_045A

## ■ FIRST USE OF THE TOOL

- Correct position of the cord when using the small coil.

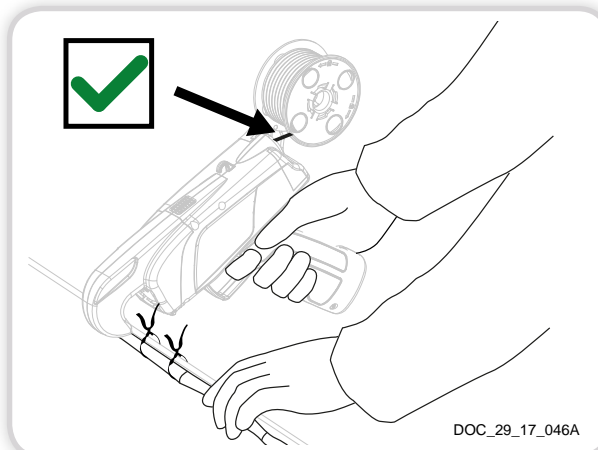

- Incorrect position of the cord when using the small coil.

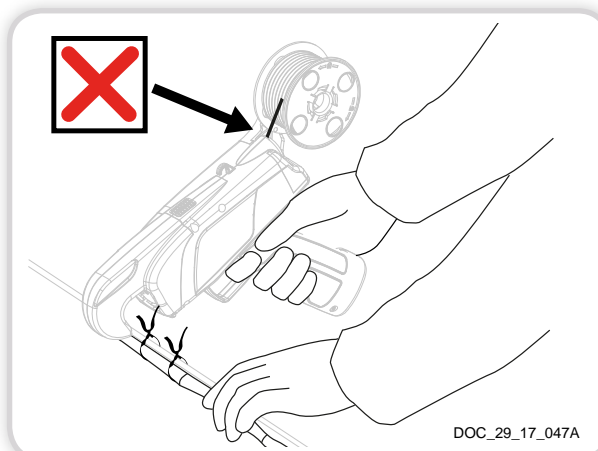

- Correct position of wood in the tying machine.

**NOTE:**  
The wood must be positioned against the swivel dispenser (11) so the twister (18) can attach the tie correctly on the metal wire.

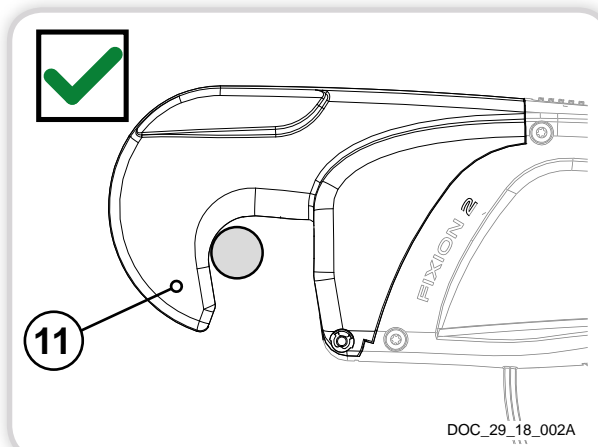

- Incorrect position of wood in the tying machine.

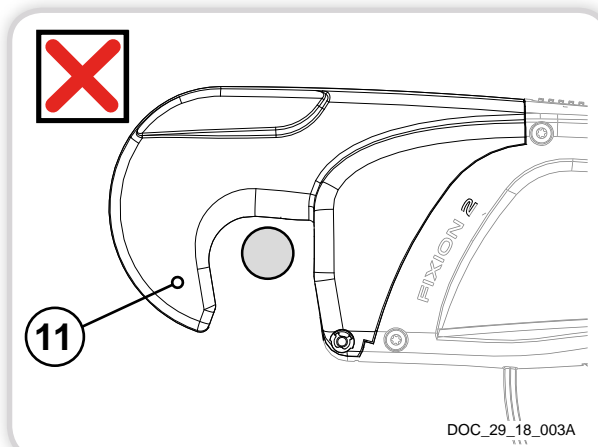

## CHARGING THE TOOL

### ► (INSTRUCTIONS BEFORE CHARGING BUILT-IN BATTERY)

- Only the battery supplied with the charger must be used. Failing to comply with this instruction leads to premature deterioration of the battery, and increases the risk of physical injury.
- Pellenc declines all responsibility if the charger is used for an application other than that specified.



**TAKE CARE:**  
BEFORE USING THE BATTERY FOR THE FIRST TIME AT THE START OF A NEW SEASON, IT MUST BE FULLY CHARGED (99% STEADY).

### ► THE DISPLAY SHOWING REMAINING BUILT-IN BATTERY CAPACITY

The battery is equipped with a gauge display (21) which allows you to see the remaining capacity. The capacity is shown as a percentage.

- If the display (21) shows **99**, the battery is fully charged.
- If after a day's work, the display (21) shows **55** there is no need to recharge the battery.
- If the display (21) shows **00**, or very close to it, it must be recharged at once.
- The battery gauge (21) must be used like a fuel gauge on a car.

### ► CHARGING THE BUILT-IN BATTERY



**TAKE CARE:**  
THE TOOL BATTERY MUST BE CHARGED ONLY USING THE TNS30W-126050 CHARGER SUPPLIED IN THE CARRYCASE.

- When the battery is discharged, the tool stops automatically. The gauge display is off and the buzzer beeps (see "**MESSAGES TABLE**" page 24).

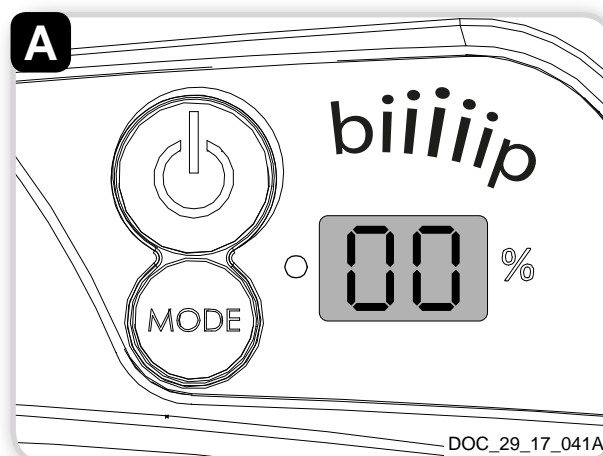

- Place the charger (25) and tying machine (8) in a dry, ventilated and dust-free room at 10-25°C.

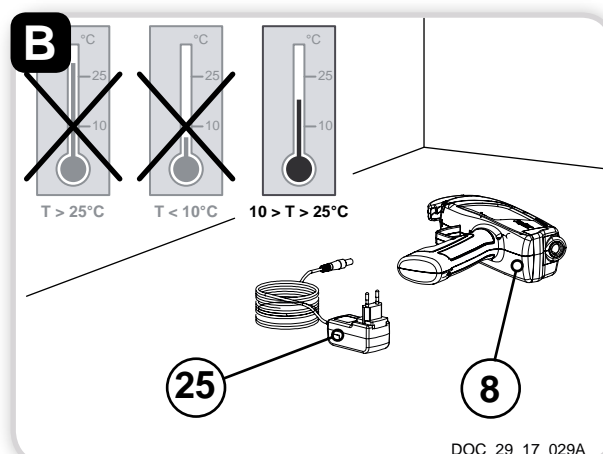

## CHARGING THE TOOL

- Use the correct adaptor (24) on the charger (25) according to your own country's standard. Press on the "PUSH" button to remove an adapter.

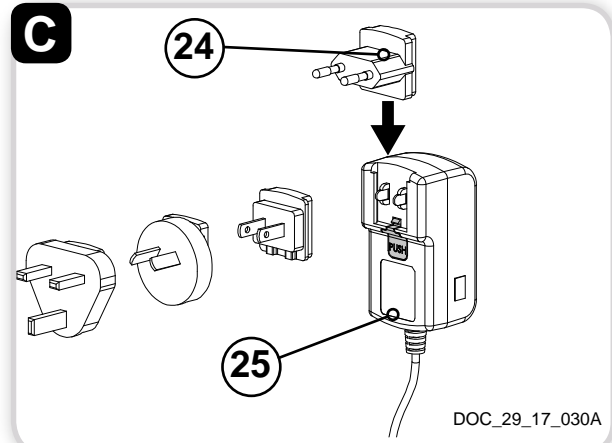

- Connect the charger connector (25) to the mains. The charger LED lights up green.

**⚠ TAKE CARE:**  
BEFORE CONNECTING THE CHARGER TO THE MAINS, CHECK THAT THE MAINS SUPPLY COMPLIES WITH THE SPECIFICATIONS GIVEN ON THE CHARGER (SEE "SPECIFICATIONS" ON PAGE 9).

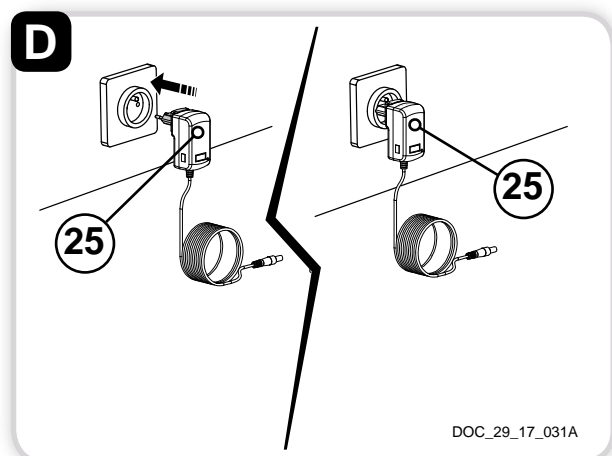

- Partly detach the guard (14) (or the adaptable dispenser (6)). If the adaptable spout (6) is fitted, make sure the tie has been withdrawn from the tool intake opening.

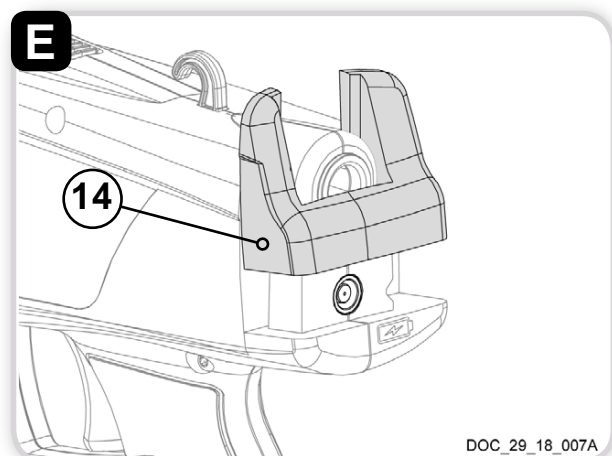

- Connect the charging cord to the tying machine's charging connector (16). The charger LED turns red.

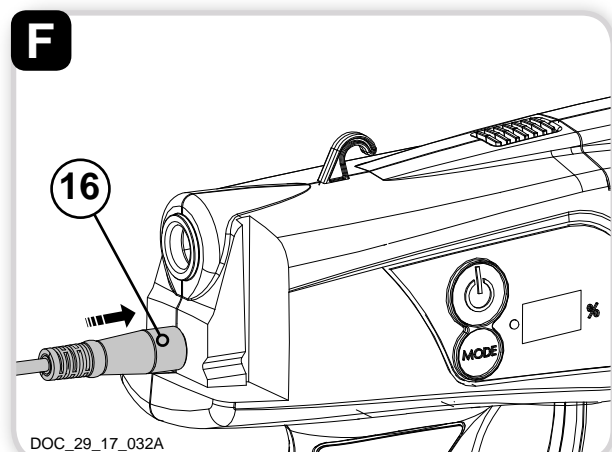

## CHARGING THE TOOL

- When the gauge display (21) flashes, the battery is charging. Charging is complete when the message **99** appears steadily on the gauge display (21).

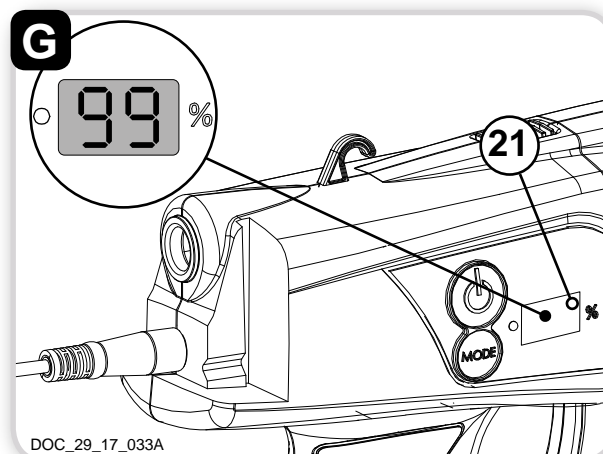

- Once the battery is charged, disconnect the charging lead on the battery first, then the charger mains connector (25).

### NOTE:

After a long storage period (new battery, winter storage etc.), when you disconnect the charger, the charge level indicator may display a value of less than 99%.

This is a normal phenomenon which can reoccur for up to 5 charge cycles with normal use between each charge.

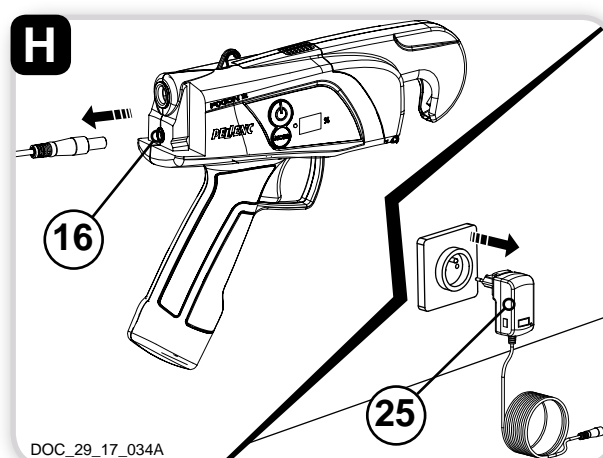

- Replace the guard (14) on the back of the tying machine (or the adaptable dispenser (6)).

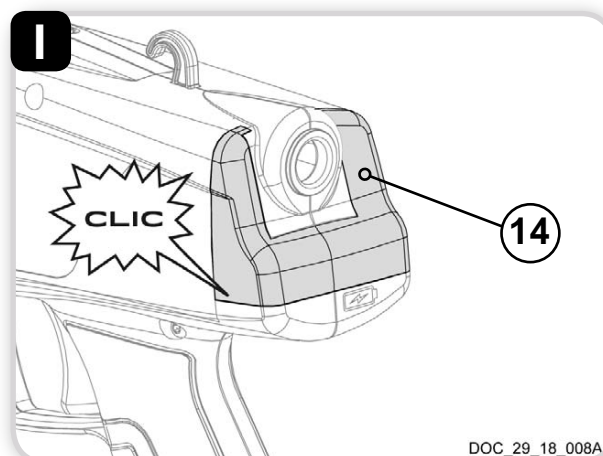

## ■ MAINTENANCE

### ► CHARGER

This does not need any particular maintenance, but must be kept in a dry, ventilated, dust-free place, away from heat. If the indicator light does not come on when charging:

- Disconnect the charger power connector.
- Check the mains supply.
- Reconnect. If the charger still does not work, return the complete equipment in its original packaging to a certified repair service.



**TAKE CARE:**  
**NEVER TRY TO OPEN ONE OF THE COMPONENTS OTHER THAN THOSE SPECIFIED IN THIS MANUAL.**

### ► BUILT-IN BATTERY

If your tying machine no longer works:

- Checking nothing is blocking the passage of the tie: Repeat the procedure in the “end of coil” section pages 12 - 13.
- Check the battery charge level.
- Press the tool on/off button.
- If the tying machine still does not work, return the complete equipment in its original packaging to a certified repair service.



**TAKE CARE:**  
**NEVER TRY TO OPEN ONE OF THE COMPONENTS OTHER THAN THOSE SPECIFIED IN THIS MANUAL.**

### ► MISC. MAINTENANCE

Make sure your tying machine continues to work properly by cleaning it often.

To do this:

- Keep the tie passage clean, by using compressed air through the front part and inside the machine. Avoid using solvents such as trichlorethylene, white spirit, petrol, etc. If necessary, remove the upper guide (13) and hold the trigger (19) for about 3 seconds to release the rod in its max upper position. Once cleaning is finished, press the trigger (19) to return the tie hook (12) to its initial position, and replace the upper guide (13).



**TAKE CARE:**  
**DO NOT OIL THE CENTRAL PART WHERE THE CORD PASSES THROUGH, AS THIS COULD CAUSE A MALFUNCTION.**

- Do not leave the tying machine on the ground or exposed to the elements.
- At least once a year, or every 200,000 ties, return your tying machine in its original packaging to an approved repair shop, for a proper overhaul to ensure a long life for your tool.

### Spares references:

Fixion 2 wearing parts kit Ref. 140588

Go to your dealer to change this kit.

## ■ MAINTENANCE

### ► BUILT-IN BATTERY REPLACEMENT



**TAKE CARE:**  
THE BATTERY MUST BE REPLACED ONLY BY AN APPROVED DISTRIBUTOR.

### ► WHEN NOT IN USE

- Store the tying machine and charger in their original carry-case, away from heat, dust and moisture, and check the tool is turned off (power indicator light on the tool off).
- In order to conserve a long battery life and prevent deterioration, the battery must be charged when stored and recharged every 24 months if it is not used.
- For more information, consult your approved repairer or contact us.



**TAKE CARE:**  
NEVER ATTEMPT TO DISMANTLE THE TYING MACHINE, UNDER PENALTY OF CANCELLATION OF THE WARRANTY. CONTACT YOUR AUTHORISED REPAIR PERSON.

## INCIDENTS

### ► SUMMARY OF CHARGE INDICATOR AND BEEP MESSAGES

NORMAL MESSAGES	
USAGE	
88 fixed	Battery charge level (0 to 99)
00 with 1 beep per minute	Battery empty, recharge immediately
00 flashing with 1 beep every 10 seconds	Stop using, recharge immediately
CHARGING	
88 flashing every 4 seconds	Battery charge level (0 to 99)
99 fixed	Charging complete
STORAGE	
88 flashing	Auto discharge indicator after 10 days unused (final threshold <30%).
DEGRADED MODE MESSAGES	
USAGE	
°C and 55 alternately	Stop the tool; the battery temperature is too high
Long beep and 1 short beep	Stop the tool: intensity is too high
Long beep and 4 short beeps	Stop the tool; the tool temperature is too high
CHARGING	
°C and 00 alternately	Charge interrupted: Battery temperature too low
°C and 45 alternately	Charge interrupted: Battery temperature too high
FAULT MESSAGES	
USAGE	
88 and beeps every 2 minutes for 24 hours	Voltage too low after 3 hours of non-use. Recharge battery immediately
CHARGING	
Pb and bR alternating and continuous beep	Battery problem
Pb and CH alternately	Charger problem

If your tool no longer works:

- 1– Turn off the tool with the off button (power indicator light off).
- 2– Check the battery is charged, as shown on the gauge display.
- 3– Checking nothing is blocking the passage of the tie: Repeat the procedure in the “end of coil” section pages 12 - 13.
- 4– Clean the tool (see page 22).
- 5– Turn on the tool with the on button (power indicator light on).
- 6– Press the trigger.
- 7– If the tool does not work, return the complete equipment in its original packaging to a certified repair service.



#### TAKE CARE:

NEVER ATTEMPT TO DISMANTLE THE TYING MACHINE, UNDER PENALTY OF CANCELLATION OF THE WARRANTY. CONTACT YOUR AUTHORISED REPAIR PERSON.



## PELLENC WARRANTY AND AFTER SALES SERVICE

### I. Legal warranty

#### A. Warranty against latent defects

Apart from the commercial warranty provided for under Article II, Article 1641 of the Civil Code provides that «the seller is bound to a warranty on account of latent defects of the object sold which render it unfit for the use for which it was intended, or which would impair said use to the extent that the buyer would not have acquired it, or would only have given a lesser price for it, had he known of them».

Article 1648 of the Civil Code «The action resulting from latent defects must be brought by the purchaser within two years after the discovery of the defect. «

#### B. Legal warranty of conformity

Article L.217-4 of the Consumer Code «The seller delivers goods in conformity with the contract and is liable for defects of conformity existing upon delivery.

The seller is also liable for any lack of compliance resulting from the packaging, assembly or installation instructions whenever its contractual liability is engaged in this regard or the latter are carried out under its responsibility

Article L.217-5 of the Consumer Code «The goods are comply with the contract:

1) If they are suitable for the purpose usually expected of similar goods and, where applicable:

- If it matches the description given by the seller and possess the qualities that were presented to the buyer in the form of a sample or model;

- If it has the qualities that a buyer can reasonably expect given the public statements made by the seller, the producer or its representative, especially in advertising or labelling;

2. Or, if it has the characteristics defined by mutual agreement of the parties or is fit for any particular purpose that the buyer made known to the seller and that the latter accepted.

Article L.217-12 of the Consumer Code «legal action resulting from lack of conformity lapses two years after delivery of the goods».

### II. Pellenc Commercial Warranty

#### A. Contents

##### 1. General Information

In addition to legal warranties, client users benefit from the commercial warranty on PELLENC products covering the exchange and replacement of parts recognised out of use, caused by machining defects, assembly defects or material defects, whatever the cause.

The warranty forms an inseparable whole with the product sold by PELLENC.

##### 2. Spare Parts

The commercial warranty also covers original PELLENC spare parts, excluding labour and to the exclusion of certain parts of each product provided at delivery.

#### B. Duration of the warranty

##### 1. General Information

PELLENC products are guaranteed under the commercial warranty as from delivery to the customer for a period of two (2) years for products connected to a PELLENC battery, and for a period of one (1) year for other PELLENC products.

##### 2. Spare Parts

PELLENC spare parts replaced under the product warranty are guaranteed under the commercial warranty as from delivery of the PELLENC product to the customer for a period of two (2) years for products connected to a PELLENC battery, and for a period of one (1) year for other PELLENC products.

In the case of products connected to a Pellenc battery, parts that are replaced in the under the product warranty after the 12th month of use, are covered for a period of one (1) year.

#### C. Warranty exclusions

Excluded from the commercial warranty are products that have been subject to abnormal use, or were used under conditions and for purposes other than those for which they were manufactured, especially in the case of non-compliance with conditions stipulated in this user manual.

It does not apply in case of shock, fall, neglect, lack of supervision or maintenance or in case of transformation of the product. Also excluded from the warranty are products that have been subject to tampering, alteration or modification by the client user.

Wear parts and/or consumables cannot be covered by the warranty.

### III. Implementation of the commercial warranty

#### 1. Product commissioning and commissioning declaration

The DISTRIBUTOR undertakes to complete the computer commissioning declaration form, no later than eight days after the delivery of the property to the user customer, in order to activate the latter on the www.pellenc.com website under «warranties and training» in the «extranet» menu, using the identifier previously provided to them by PELLENC.

Failing that, commissioning declaration will not be effective and implementation of the PELLENC commercial warranty will not occur. As a consequence thereof, the DISTRIBUTOR must ensure the financial burden of its intervention under the warranty without being able to pass on the cost to the client user.

The DISTRIBUTOR shall also undertake to complete the warranty card or the certificate of warranty and commissioning for self-propelled equipment provided with the product after having the client user sign and date it.

### IV. Paid after-sales service

#### A. General Information

Malfunctions, breakdowns, breakages resulting from misuse, neglect or improper maintenance by the client user as well as malfunctions resulting from normal wear of the product are subject to the payment of after-sales service, even during the period of the legal and commercial warranty. After-sales service repairs that fall outside of the legal and commercial warranty also include maintenance, adjustments, diagnostics of all types, and cleaning without the present list being exhaustive.

#### B. Wear parts and consumables

Wear parts and consumables also fall within the after-sales service.

#### C. Spare Parts

Paid after-sales service also covers original PELLENC spare parts, excluding labour and outside the legal and commercial warranty period.

In case of replacement of original PELLENC spare parts in the context of after-sales service, said latter are covered by a warranty of one year as from the installation date.

**"EC" STATEMENT OF COMPLIANCE**

MANUFACTURER	PELLENC
ADDRESS	Quartier Notre Dame 84120 Pertuis (FRANCE)
PERSON/ENTITY AUTHORISED TO COMPILE THE TECHNICAL DOSSIER	PELLENC
ADDRESS	Quartier Notre Dame 84120 Pertuis (FRANCE)

WE HEREBY DECLARE THAT THE MACHINE HEREINAFTER REFERRED TO AS :

GENERIC DENOMINATION	TYING MACHINE
FUNCTION	INTENDED FOR ATTACHING VINE SHOOTS
COMMERCIAL NAME	FIXION 2
TYPE	FIXION 2
MODEL	FIXION 2
SERIAL No.	29S00001 - 29S49999 29T00001 - 29T49999 29U00001 - 29U49999

COMPLIES WITH THE RELEVANT PROVISIONS OF THE MACHINERY DIRECTIVE (2006/42/EC)

IS IN CONFORMITY WITH THE FOLLOWING OTHER DIRECTIVES AND/OR RELEVANT PROVISIONS :

- 2014/53/EU RED Directive
- 2014/30/EU EMC Directive
- 2003/10/EC Noise Directive
- 2002/44/EC Vibrations Directive
- 2011/65/EU ROHS Directive
- 2012/19/EU WEEE Directive
- 1907/2006 REACH Regulation
- 2006/66/EC Directive relative to batteries and accumulators

THE FOLLOWING HARMONIZED EUROPEAN STANDARDS WERE USED :

- EN 62841-1 : 2015

THE FOLLOWING OTHER STANDARDS AND TECHNICAL SPECIFICATIONS HAVE BEEN USED :

- IEC 62133-2 : 2017

**Vibration level at the maximum operating ratin**

Total vibration values (triax vector sum) determined in accordance with EN 62841-1. (Uncertainty K=1.5 m/s <sup>2</sup> )	$a_h < 2.5 \text{ m/s}^2 \text{ max.}$
---	--

**Sound level at the maximum operating ratin**

Noise value measured according to standard EN 62841-1	
Acoustic power level measured (uncertainty of K=3 dB)	$L_{WA} = 81 \text{ dB maximum}$
Level of acoustic pressure measured at the work station (uncertainty of K=3 dB)	$L_{pA} = 70 \text{ dB maximum}$

CONCLUDED AT PERTUIS, DATED 30/05/2018

JEAN MARC GIALIS

Deputy Managing Director



